

SITE EXTENT = 1461 Sq.M ✓
 TOTAL NO. OF PLOTS = 10 Nos. ✓

NOTE:

MEASUREMENTS ARE INDICATED EXCLUDING SPLAY DIMENSIONS

CONDITIONS :

- (I) THE FOLLOWING CONDITIONS OF PWD VIDE THE CE, WRD, CHENNAI REGION, CHEPAUK, CHENNAI-5, LETTER NO.T1/PERUMBAKKAM/BOLLINENI DEVELOPERS/CMDA/2016, DATED:29.06.2016 ARE TO BE COMPLIED BY THE APPLICANT BEFORE ISSUING OF THE LAYOUT APPROVAL BY THE COMPETENT AUTHORITY (LOCAL BODY).
- 1) THE EXISTING GROUND LEVEL OF THE SITE SHOULD BE RAISED TO A MINIMUM LEVEL OF (+)7.900M (i.e. 1.000M ABOVE THE MFL OF THE EXISTING PERUMBAKKAM SURPLUS COURSE) WITH FILLING VARYING FROM 1.340M TO 1.580M OVER THE ENTIRE AREA OF THE APPLICANT SITE, SO, AS TO AVOID INUNDATION FROM THE PERUMBAKKAM SURPLUS COURSE.
 - 2) PROPER STORM WATER DRAINAGE CHANNEL OF SIZE 0.60x0.90M SHOULD BE CONSTRUCTED ALL-ROUND THE SITE BY THE APPLICANT AT THEIR OWN COST AND THIS CHANNEL LINKED WITH THE EXISTING ROAD DRAIN AT IN FRONT OF THE SIDE (NORTHERN SIDE) OF THE SITE AS PER THE SKETCH FURNISHED BY PWD FOR DRAIN OUT THE RAIN WATER.
 - 3) NO SEWAGE SHOULD BE LET INTO THE ADJACENT SITE AND NECESSARY PERMISSION SHOULD BE GOT BY THE APPLICANT FROM THE COMPETENT AUTHORITIES FOR THE DISPOSAL OF SEWAGE.
 - 4) THE APPLICANT SHOULD PROVIDE RAIN WATER HARVESTING ARRANGEMENTS AT THE ABOVE SITE AT HIS OWN COST.
 - 5) THE APPLICANT SHOULD MAKE ARRANGEMENT TO COLLECT THE GARBAGES WITHIN THE PREMISES AND HAS TO BE DISPOSED OF AS PER EXISTS NORMS.
 - 6) THE WRO/PWD OFFICIALS SHOULD NEVER BE OBJECTED TO INSPECT THE SITE AT ANY TIME DURING EXECUTION OF WORKS.
 - 7) NECESSARY DEMARCATION SHOULD BE DONE AT THE NORTHERN SIDE BY THE REVENUE DEPARTMENT IN THE PRESENCE OF THE W.R.O OFFICIALS AND THE APPLICANT SHOULD FIX THE BOUNDARY POSTS OF SIZE 0.15x0.15x1.15M.

(II). DR RULE NO: 29 (11)

THE COST OF LAYING IMPROVEMENTS TO THE SYSTEMS INRESPECT OF ROAD, WATER SUPPLY, SEWERAGE, DRAINAGE OR ELECTRIC POWER SUPPLY THAT MAY BE REQUIRED AS ASSESSED BY THE COMPETENT AUTHORITY, SHALL BE BORNE BY THE APPLICANT.

(III) LOCAL BODY SHOULD ENSURE COMPLIANCE OF ALL THE CONDITIONS STIPULATED BY PWD IN THEIR LETTER NO.T1/PERUMBAKKAM/BOLLINENI DEVELOPERS/CMDA/2016, DATED:29.06.2016. AND SHALL OBTAIN A LETTER FROM PWD CONFIRMING THE COMPLIANCE OF THE CONDITIONS BEFORE THE SANCTION AND RELEASE OF THE LAYOUT.

LEGEND:

- ▬ SITE BOUNDARY
- ▬ EXISTING ROAD

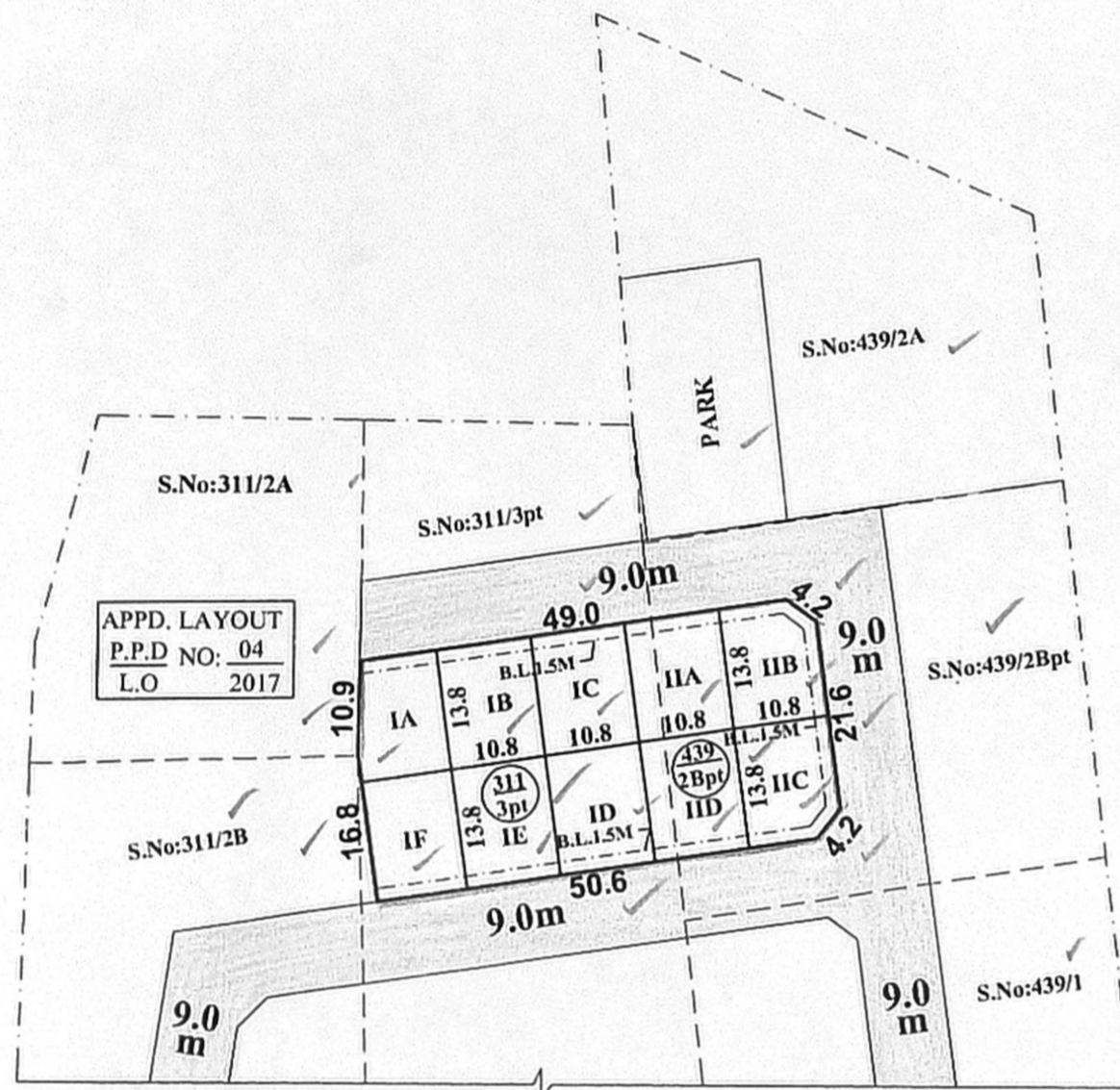

CONDITIONS:

THE LAYOUT APPROVED IS VALID SUBJECT TO OBTAINING SANCTION FROM THE LOCAL BODY CONCERNED.

P.P.D NO: 54
 L.O 2018
APPROVED

VIDE LETTER NO : L1 / 8540 / 2018
 DATE : / 08 / 2018

FOR MEMBER SECRETARY
 CHENNAI METROPOLITAN
 DEVELOPMENT AUTHORITY

PREPARED BY P.A.IV (S.M)

CHECKED BY P.A.II (A.A)

A.P.(S.A)

ST.THOMAS MOUNT PANCHAYAT UNION

SKETCH SHOWING THE CONVERSION OF PUBLIC PURPOSE PLOT Nos: I & II LYING IN THE APPROVED LAYOUT P.P.D/L.O.No:04/2017 INTO RESIDENTIAL USE AND LAYING OUT OF THE SAME INTO HOUSE SITES IN S.Nos: 311/3pt, 439/2Bpt OF PERUMBAKKAM VILLAGE.

SCALE : 1:800 (ALL MEASUREMENTS ARE IN METRE.)

